

GENERAL NOTES

- A. CONTRACTOR TO PROVIDE CLEANUP ON A DAILY BASIS. NO TRASH SHALL BE STORED IN THE BUILDING OR BURNED ON SIRE. DEBRIS IS TO BE REMOVED FROM THE BUILDING AND DISPOSED OF IN AN APPROVED LEGAL MANNER.
- B. CONTRACTOR SHALL ERECT DUST BARRIERS WHERE NECESSARY TO LIMIT MOVEMENT OF DUST INTO ADJACENT SPACES. FULL CLEAN-UP OF ALL ROOMS OF BUILDING REQ'D UPON COMPLETION.
- C. CONTRACTOR MUST REPAIR, PATCH, AND REFINISH WALLS, CEILINGS, AND FLOORS ADJACENT TO LOCATIONS WHERE EXISTING CONSTRUCTION IS CALLED TO BE DEMOLISHED. REPAIR WORK MUST MATCH ADJACENT SURFACES IN ALL RESPECTS.
- D. SEE SHEET A-3 FOR NEW FINISHES. NEW THRESHOLDS AND FLOORING TRANSITION STRIPS SHALL BE INSTALLED WHERE DIFFERENT FLOORING TYPES MEET AND AS OTHERWISE INDICATED ON DRAWINGS. TRANSITION TYPES TO BE PRIOR APPROVED BY ARCHITECT.

KEY NOTES

1. PROVIDE NEW DOUBLE 2X TREATED STUDS AT JAMBS, CONTINUOUS TO STRUCTURE ABOVE (TYP. ALL WINDOWS).
2. NEW SOLID SURFACE COUNTERTOP PER DETAILS ON SHEET A-2.
3. INSTALL NEW HOLLOW METAL DOOR AND FRAME INTO OPENING FOR WEATHERTIGHT CONDITION. REWORK JAMBS AND HEADER AS NECESSARY TO SUPPORT NEW DOOR AND FRAME. REINSTALL SALVAGED DOOR ALARM DEVICE. SEE SPEC SECTION 08111 FOR ADD'L INFO.
4. PROVIDE DOUBLE 2X TREATED WOOD FOR HEADER ABOVE NEW OPENING. SECURE TO NEW DOUBLE STUDS (INDICATED IN KEY NOTE 1 ABOVE).
5. SET SALVAGED SINK INTO NEW SOLID SURFACE COUNTERTOP AND INSTALL NEW ADA COMPLIANT GOOSENECK FAUCET (MODEL 895-317VE2805FAB BY CHICAGO FAUCETS OR PRIOR APPROVED EQUAL) AND 3/8" FLEXIBLE METAL C.P. RISERS WITH WHEEL HANDLE STOPS. PROVIDE ALL PIPING FROM SUPPLIES TO FIXTURE, INCLUDING 1-1/2" TAILPIECE AND 1-1/2" C.P. "P" TRAP WITH OFFSET TO WASTE WALL. PROVIDE ADA LAV SHIELD TO ENCAPSULATE ALL PIPING AND VALVES.
6. INSTALL NEW ALUMINUM-CLAD WOOD WINDOW. SEE DETAILS, ELEVATIONS, AND SPEC SECTION 08553 FOR ADD'L INFO.
7. UPON COMPLETION OF NECESSARY FRAMING WORK AND SEALING OF NEW WINDOW FOR WEATHERTIGHTNESS, PATCH AND REPAIR GYPSUM BOARD INTERIOR AND BRICK FACADE EXTERIOR, MATCHING ADJACENT WALLS IN ALL RESPECTS (TYP. ALL WINDOWS).
8. INSTALL NEW TRANSITION STRIP BETWEEN FLOOR FINISHES. SEE A-3 FOR ADD'L INFO.
9. INSTALL NEW SHUTTERS. SEE ELEVATIONS FOR ADD'L INFO.
10. INSTALL NEW FLUSH WOOD DOOR, MATCHING EXISTING IN ALL RESPECTS. PREPARE NEW DOOR TO EXISTING FRAME, HINGE, AND STRIKE LOCATIONS. SEE OPENING SCHEDULE ON SHEET A-2.
11. INSTALL NEW THRESHOLD AT EXTERIOR DOOR AND WORK TO NEW FLOOR FINISH PER A-3. PROVIDE FLUSH, WATER-SEALED CONDITION.
12. REPAIR DAMAGED WOOD MULLION ON WINDOW AND RESEAL GLAZING AS NECESSARY FOR WATERTIGHT SEAL. MATCH EXISTING DETAILS.
13. APPLY FAUX WOOD FINISH TO BASE OF EXISTING DOOR/WINDOW FRAME TO COVER WATER STAIN. SEE SPEC NOTES ON SHEET A-4.
14. APPLY FAUX WOOD FINISH TO BOTTOM OF WINDOW (BELOW LOWEST PANE OF GLASS) TO COVER WATER STAIN. SEE SPEC NOTES ON SHEET A-4.
15. NEW FURNITURE, NOT IN CONTRACT.
16. EXISTING SHUTTERS, NO WORK.
17. INSTALL NEW FIRE EXTINGUISHER IN FULLY RECESSED CABINET TO MATCH EXISTING UNIT. EXTINGUISHER TO BE 3A-40BC TYPE (COSMIC 6E BY J.L. INDUSTRIES OR PRIOR APPROVED EQUAL), AND CABINET TO BE FRAMELESS STAINLESS STEEL UNIT WITH TEXTURED OPAQUE BLACK DOOR, WHITE LETTERS, AND SAF-T-LOK (PANORAMA 1035Q50 BY J.L. INDUSTRIES OR PRIOR APPROVED EQUAL).
18. PATCH, PREPARE, AND PAINT HOLE IN WALL WHERE RECESSED SOAP DISPENSER WAS REMOVED.

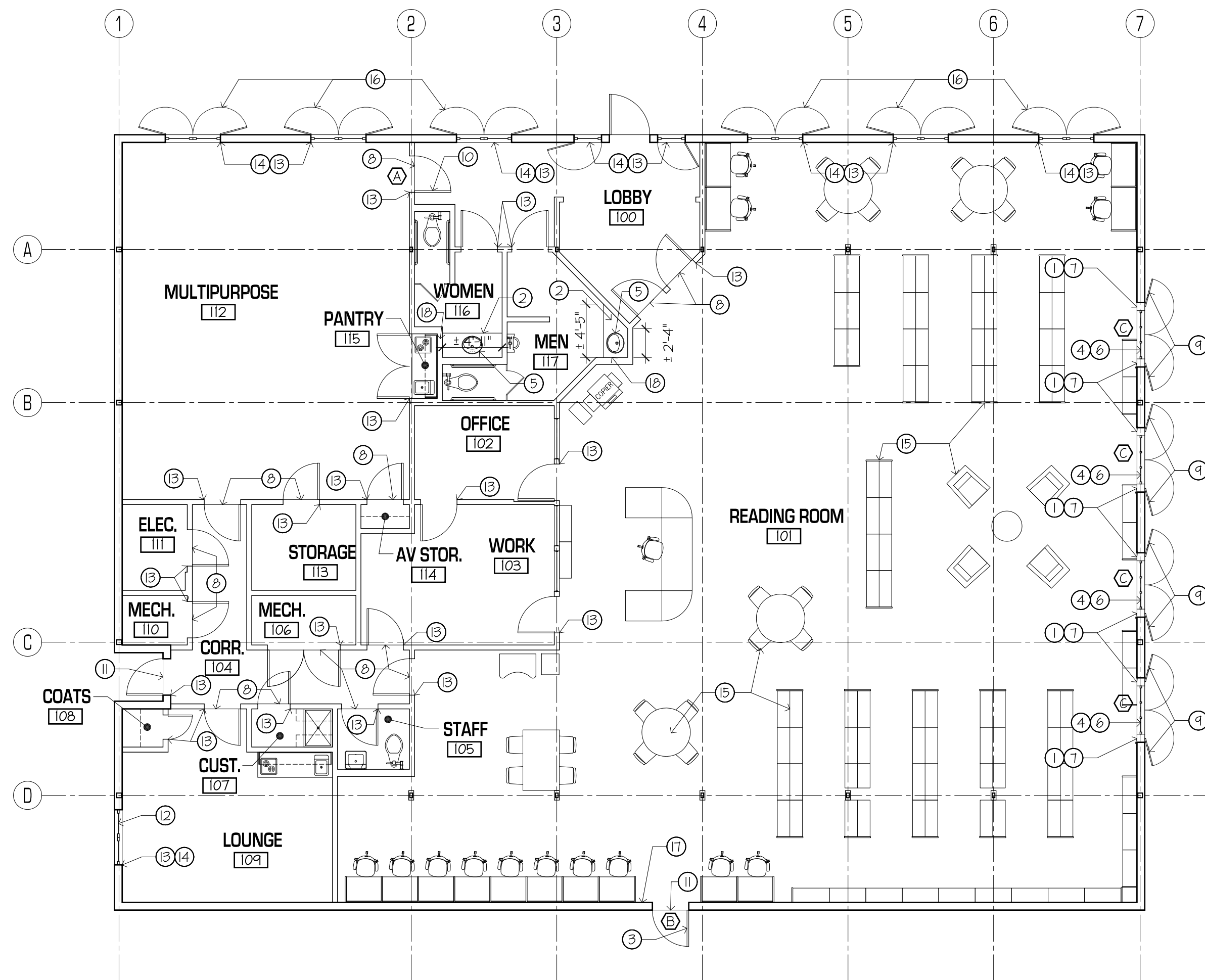

1 FLOOR PLAN
 A-1 scale: 1/8" = 1'-0" NORTH

BURGDahl & Graves
 A.I.A. ARCHITECTS
 A PROFESSIONAL CORPORATION · PHONE (504) 366-4433

RENOVATIONS TO
LIVE OAK LIBRARY
 FOR
JEFFERSON PARISH

WAGGAMAN, LA

125 ACADIA DRIVE

DATE: 01.30.2016
 DRAWN BY:
 REVISIONS:

A-1

SHEET 4 of 13